

Site name	Site code	Date of visit	OS X	OS Y	Latitude	Longitude	UTM
Greenwich 9	GR9	14/08/2007	541883	175016	51 27' 23N	0 02' 27E	31U 292329.52E, 5684317.39N

Satellite pictures

Date:
12/05/2006 -
10/09/2006

Local scale
(100 m radius)



Meso Scale
(1km radius)



Street maps

Local scale
(100 m radius)

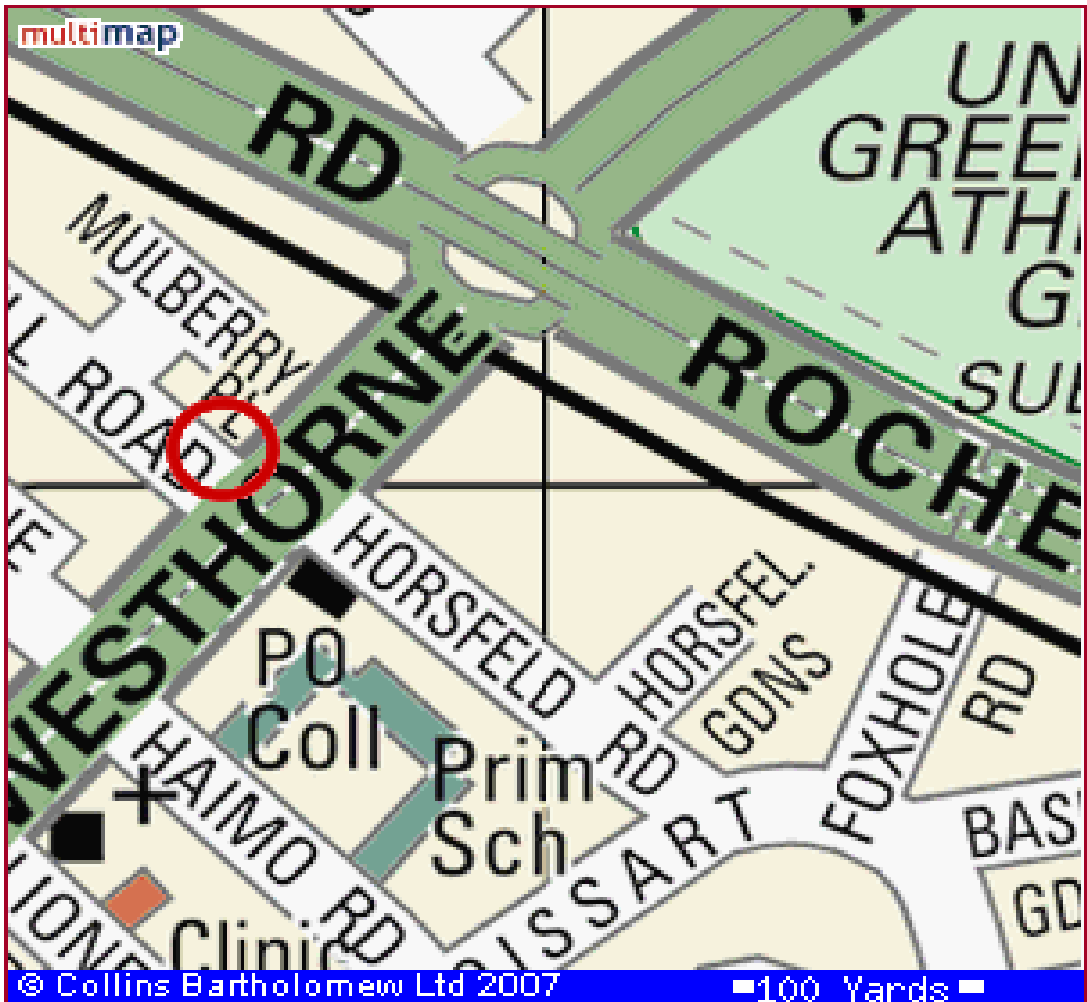

Meso Scale
(1km radius)

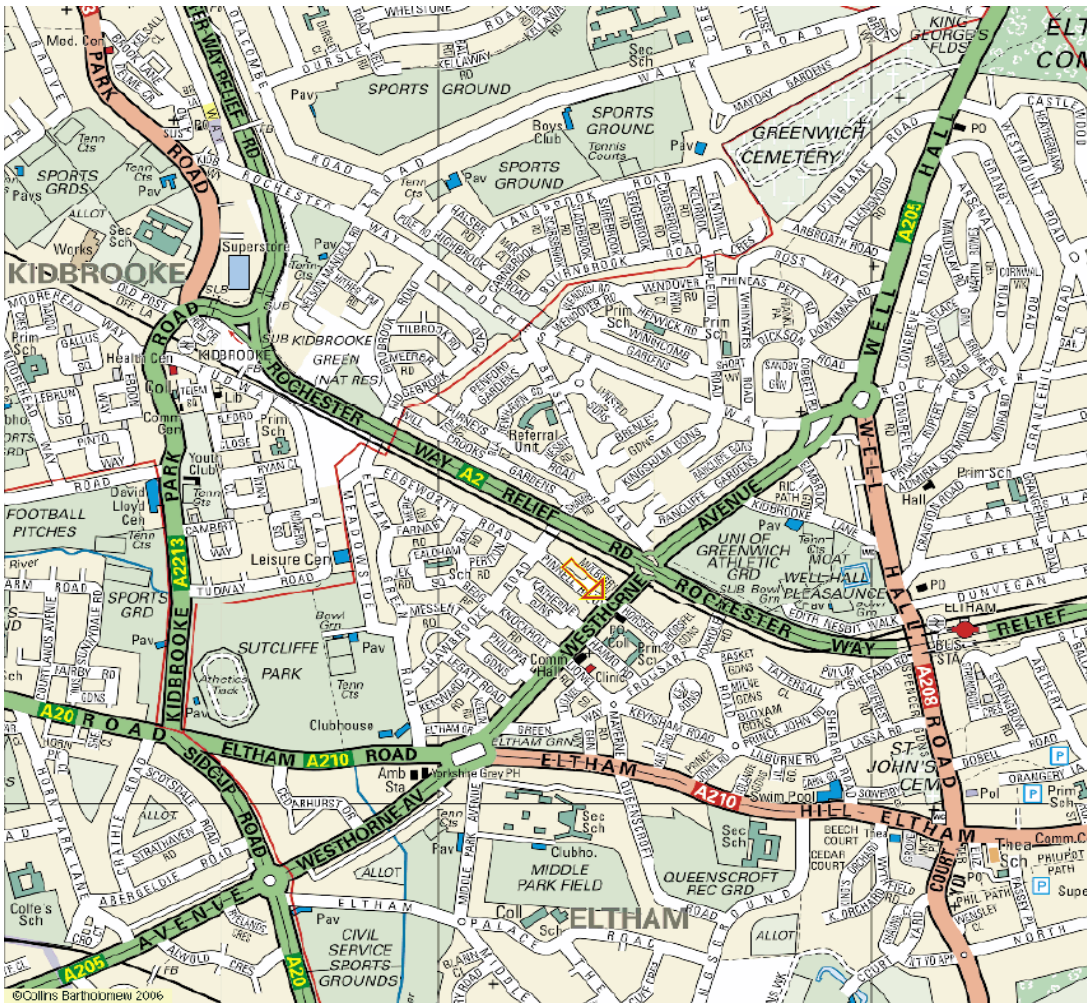

Site classification	LAQN	Station Type
	Classification	
	Roadside	

Urban climate zone	Meso (1 km radius)	Local (100 m radius)	Micro (30 m radius)
	5	3	3

% Land cover		100 m	1 km
	Vegetated	39.8	49.0
	Built over	35.1	33
	Water	0	0.2
	Road	25.1	17.8

Main Land use	Direction	Land use (MAJOR/ minor)
	N	RESIDENTIAL/ greenspace
	E	RESIDENTIAL/ greenspace
	S	RESIDENTIAL/ greenspace
	W	RESIDENTIAL/ greenspace

Site description	Meso (1 km radius)	Local (100 m radius)	Micro (30 m radius)
	Suburban housing: rows of houses/flats but lots of trees and open greenspace.	Houses and gardens alongside a busy A-road (A205) and overhead traintrack. Areas of open greenspace and natural vegetation (ie NE of station).	Quiet residential road (running from NW of station) opening out into A205.

Station photo



Plan view
diagram
(30 m radius)

KEY
□ : Tree
X : Station

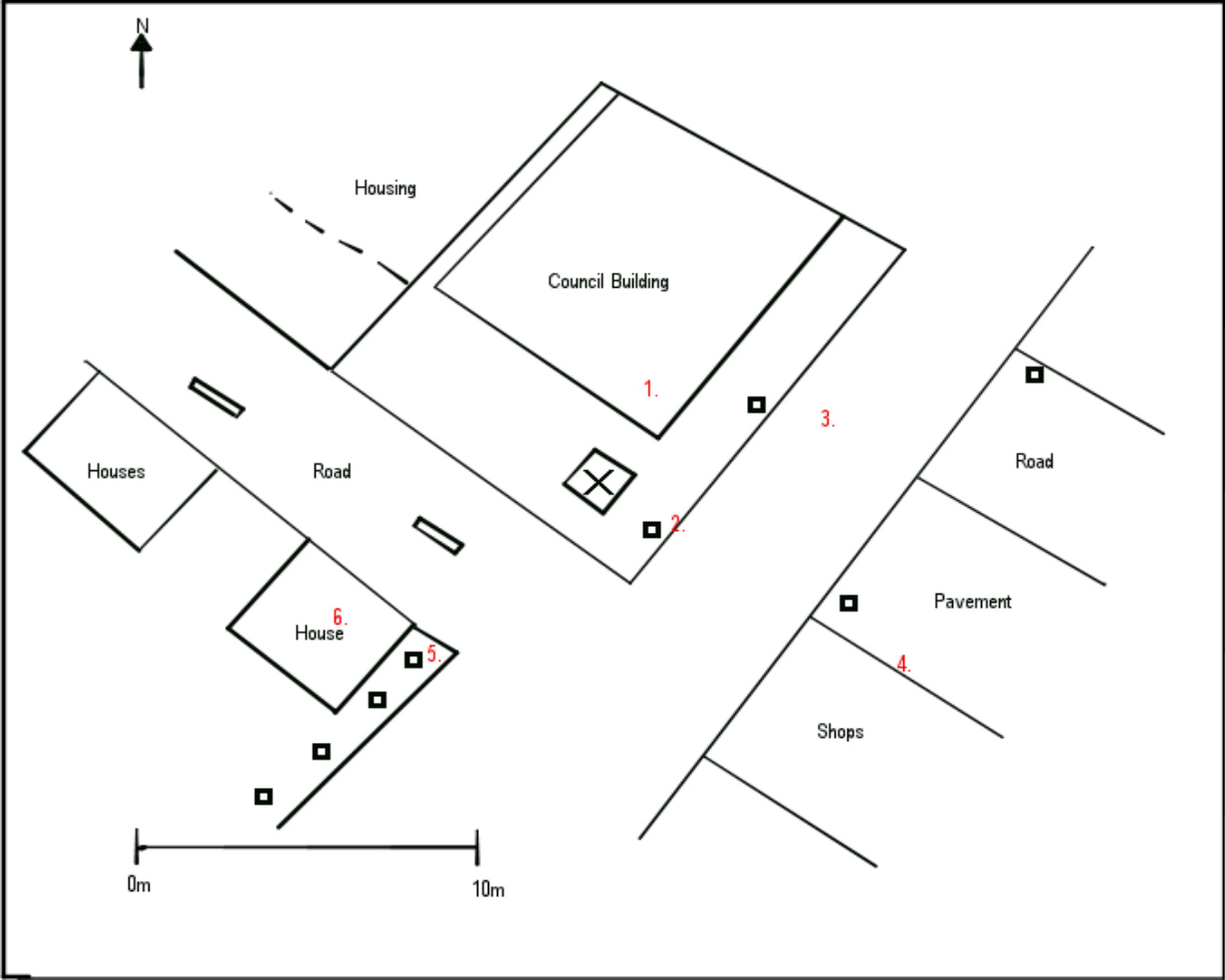

Site obstacles

Sketch key	Type	Detail	Wall material	Roof material	View from station
1	Council Building	N/a	Red brick	Grey slate	
2	Tree	Deciduous	N/a	N/a	
3	Tree	Deciduous	N/a	N/a	
4	Shops	N/a	Brown brick/ Glass shop fronts	Brown slanted slate roof, large frontage	
5	Tree	Deciduous	N/a	N/a	
6	House	N/a	Brown brick	Brown slate	

Instrument
diagram
(Plan view)

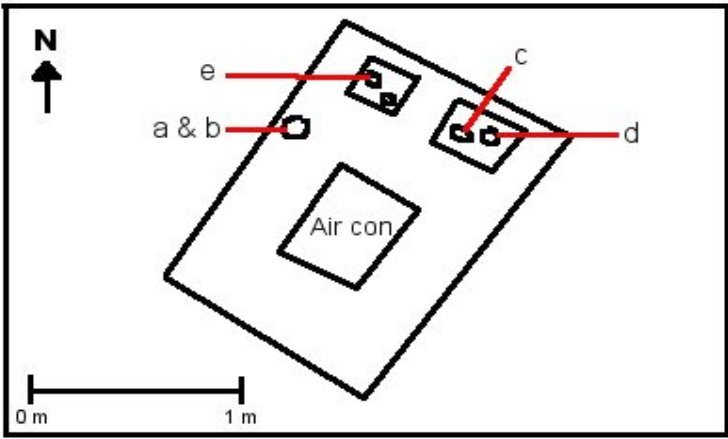

Instruments

Sketch key	Name	Variable	True height (m)	Concerns
a	Young's wind vane	Wind speed	8.29	N/a
b	Young's wind vane	Wind direction	8.29	N/a
c	RH Gauge	Relative Humidity	2.65	N/a
d	TEOM	Air Temperature	2.50	N/a
e	Sample Inlet	Air Quality	2.83	N/a

Instrument
image



Graphs
 Height vs.
 bearing

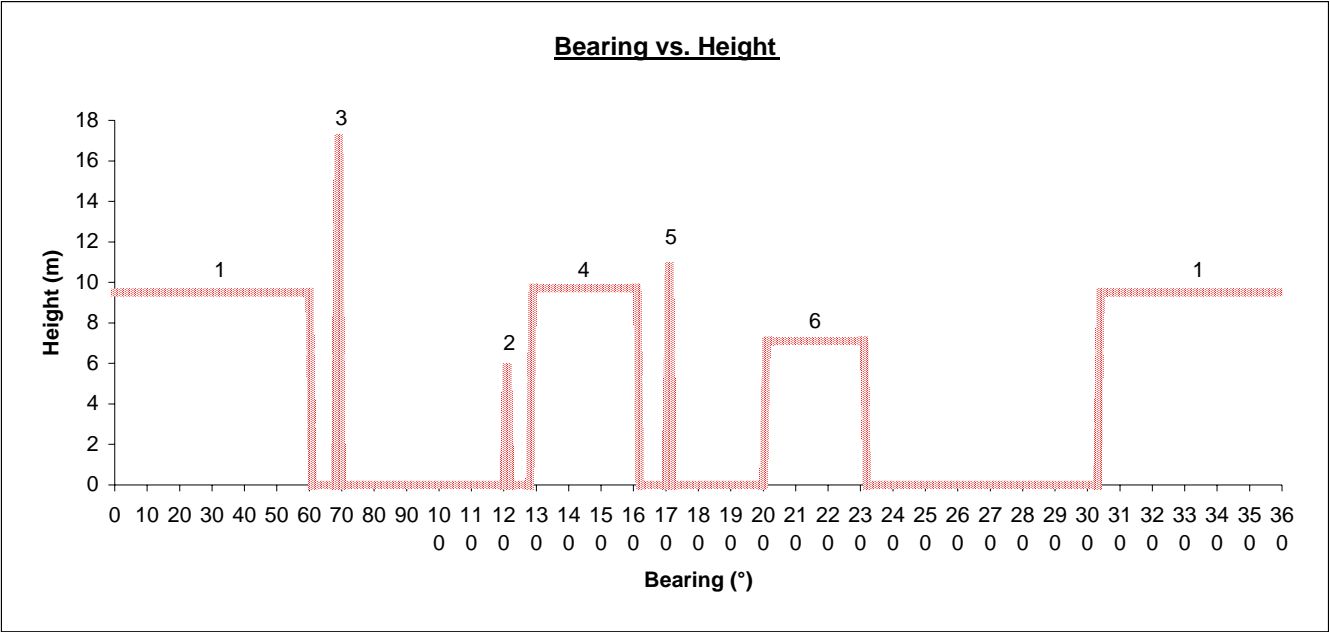

Other
 influences

Heat sources	Bearing from site (°)	Source	Location	Detail
	approx. 190 - 30	Road (A205)	North of station	Lots of traffic
	304 - 60	Building (1)	North of station	Internal heating may be an issue because of close proximity to station

Traffic	Residential road running from NW of station = quiet. A205 running from the SW of station is very busy.	Seasonal features	Summer: trees in full leaf; trees (2), (3) & (5) all deciduous.	Temporary fixtures	
					N/a

Task	Initial
Who visited the site	RW, KR
Who filed the report	KR, RE
Who produced the plots	KR

N.B.
values
given to 3
s.f.