

| Site name | Site code | Date of visit | OS X | OS Y | Latitude | Longitude | UTM |
|-----------|-----------|---------------|--------|--------|------------|-----------|--------------------------------|
| Bexley 4 | BX4 | 24/07/2007 | 552220 | 177670 | 51 28' 39N | 0 11' 26E | 31U 298649.74E, 5685356.52N |

Satellite pictures
(Google Earth)

Date:
18/09/2006 -
16/10/2006

Local scale
(100 m radius)



Meso Scale
(1km radius)



Street maps

Local scale
(100 m radius)

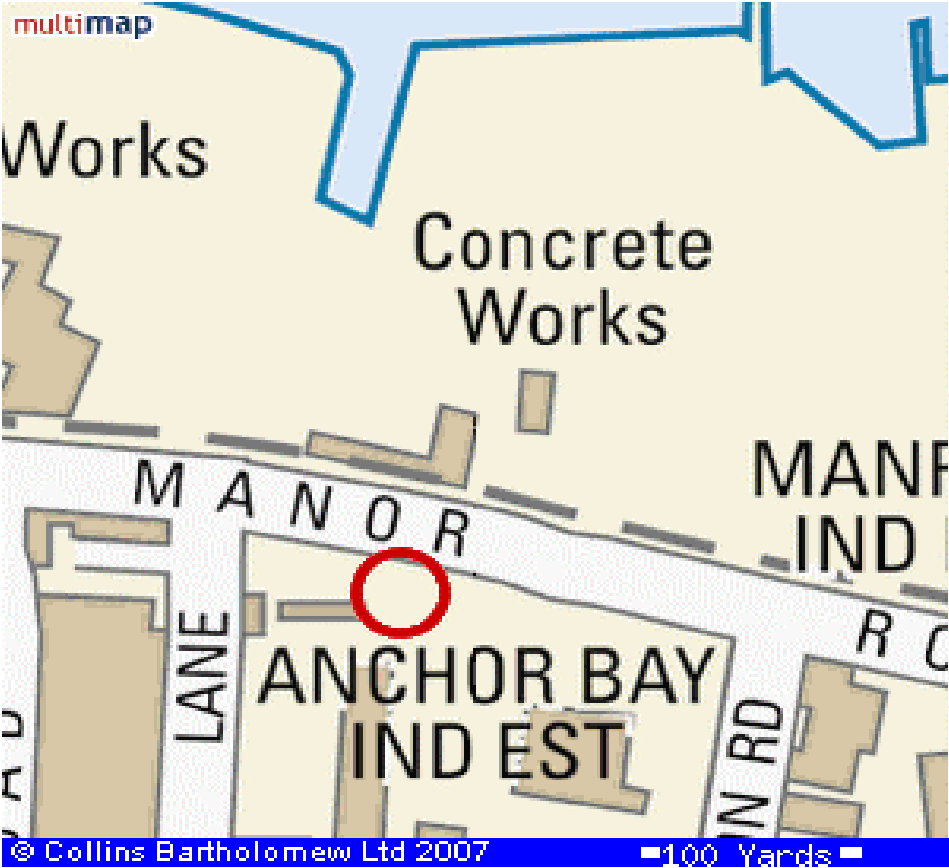

Meso Scale
(1km radius)



| | | | | | | |
|---------------------|---------------------|----------------------|--------------------|-------------|---------------------|----------------------|
| Site classification | LAQN Classification | Station Type | Urban climate zone | Meso (2 km) | Local (1 km radius) | Micro (100 m radius) |
| | Industrial | Urban Meteorological | | 4 | 4 | 4 |

| | | | |
|--------------|------------|-------|------|
| % Land cover | | 100 m | 1 km |
| | Vegetated | 6.8 | 29.1 |
| | Built over | 82.3 | 35.5 |
| | Water | 0 | 28.3 |
| | Road | 10.9 | 7.1 |

| | | |
|---------------|-----------|-------------------------|
| Main Land use | Direction | Land use (MAJOR/minor) |
| | N | INDUSTRIAL/ river |
| | E | INDUSTRIAL/ green |
| | S | INDUSTRIAL/ residential |
| | W | INDUSTRIAL/ redisential |

| | | | |
|------------------|--|--|---|
| Site description | Meso (2 km radius) | Local (1km radius) | Micro (100 m radius) |
| | Large proportion of the land used residentially, buildings tend be two storeys high. The river covers more than a quarter of the land. | Large proportion of recreational and residential land, generally the land is built over, with less vegetation. | The site is surrounded by warehouses and heavily used roads. The site is on a grass area near to the National construction college. |

Station photo



Plan view
diagram
(30 m radius)

KEY
□ : Tree
X : Station

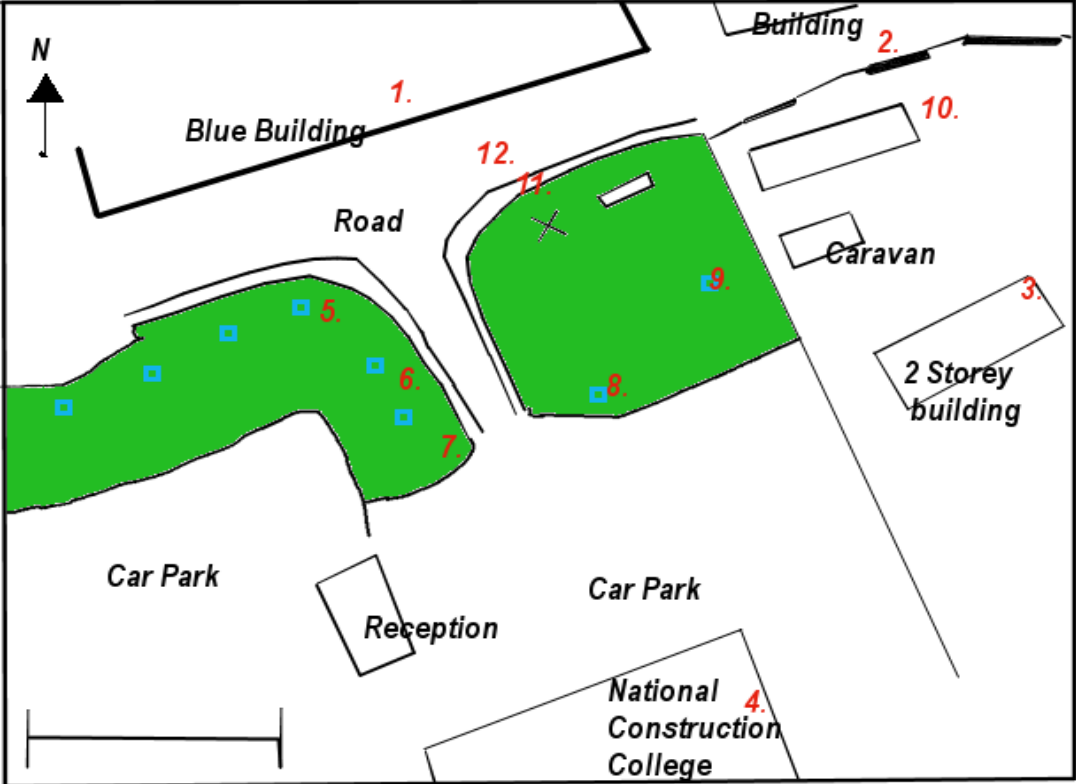

Site obstacles

| Sketch key | Type | Detail | Wall material | View from station |
|------------|-----------|-------------------|---------------|-------------------|
| 1 | Office | N/a | Plaster | |
| 2 | Office | Converted Housing | Brown Brick | |
| 3 | Warehouse | N/a | Red Brick | |
| 4 | Billboard | N/a | Steel/ Wood | |
| 5 | Tree | Deciduous | N/a | |
| 6 | Tree | Deciduous | N/a | |
| 7 | Tree | Deciduous | N/a | |

Instrument
diagram
(Plan view)

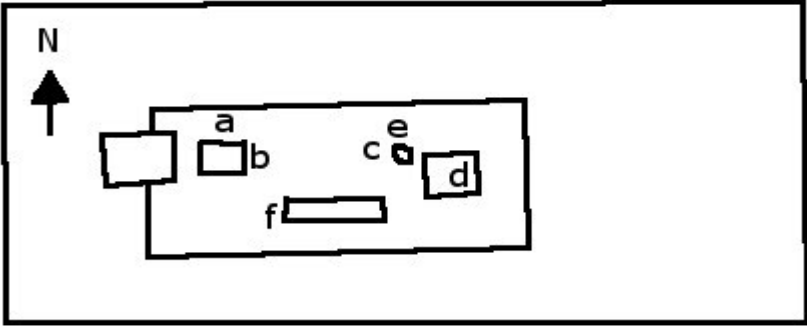

Instruments

| Sketch key | Name | Variable | True height (m) | Concerns |
|------------|-----------------------|----------------|-----------------|---|
| a | TEOM | Pressure | N/a | None |
| b | TEOM | Air temp | 2.52 | May be too close to air conditioning (f). |
| c | Young's Anemometer | Wind speed | 8.02 | Billboard (4) may obstruct windflow |
| d | TEOM | Air quality* | 2.77 | None |
| e | Young's Wind vane | Wind direction | 8.02 | Billboard (4) may obstruct windflow |
| f | Air conditioning unit | N/A | 2.77 | N/A |

* Nox, PM10.

Instrument
images



Graphs

Height vs. bearing

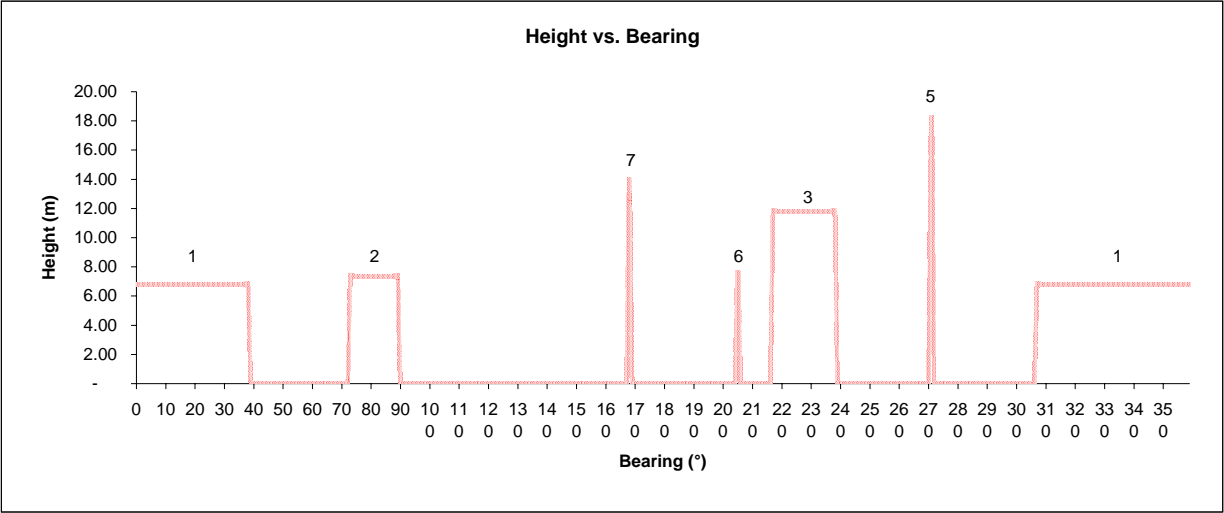

Other influences

Heat sources

| Bearing from site (°) | Source | Location | Detail |
|-----------------------|------------------|--------------|-----------------------|
| 180 | Air conditioning | On cabin | Fan with air con unit |
| 307-38 | Building (1) | Across road | Closest building |
| 95 | Unidentified box | East of site | Brick walled |

Traffic

Fairly busy - large lorries, articulated vehicles.

Seasonal features

Summer

Temporary fixtures

N/A

| Task | Initial |
|------------------------|---------|
| Who visited the site | RW, KR |
| Who filed the report | KR, RE |
| Who produced the plots | KR |

N.B. values given to 3 s.f.